

### I. ADJUSTMENT

Centerlines are provided on each end of the unit for proper alignment on the door.  
The side angles are adjusted so they are incontact with the door but sufficiently loose so the unit slides on the door

### 2. OPERATION

If the groove runs the full length of the door, the unit can be started at one end of the door and run the full length.

If the groove doesn't run the full length it is recommended that some type of stop be clamped to the door to prevent over-travel. The Masterline Stylizer Stop (#MFG500) can be used if the groove needs to be within approximately 7 inches from the end of the door. When doing this operation, the running unit should be carefully rotated into the door edge slowly until the fixture is resting on the door edge. The groove is then run between the two stops. If you have any questions or concerns, call your Norfield Industries rep before proceeding further: 1-800-824-6242

### OPERATIONAL INSTRUCTIONS



The Stylizer II is designed to make a EuroGroove on the edge of a door.

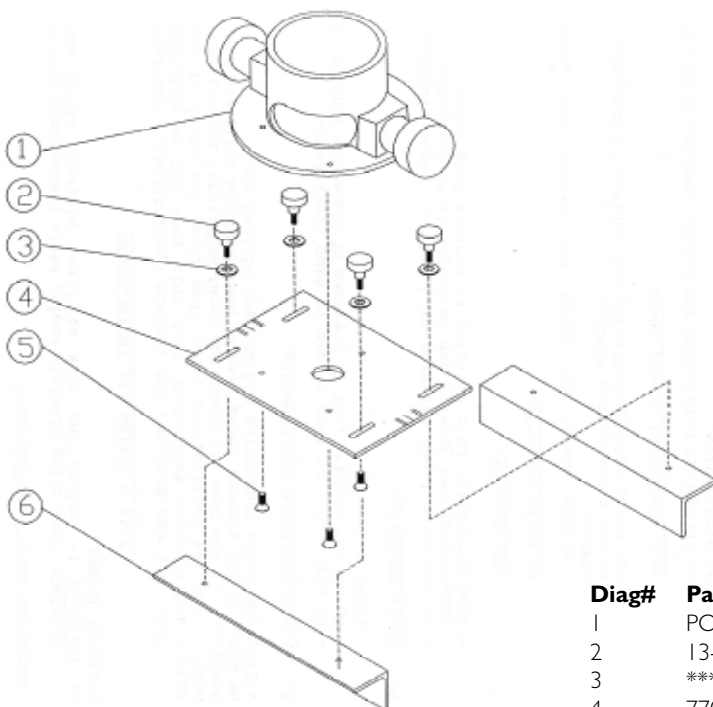

Diag#	Part#	Description (Qty)
1	POR690	PORTER CABLE 690 ROUTER (1)
2	13-595	REID DK-26 KNOB (4)
3	***	5/16 FLAT WASHER (4)
4	7702-100	BASE PLATE ASSEMBLY (1)
5	***	PORTER CABLE FLAT HEAD BOLT (3)
6	7702-101	FENCE ASSEMBLY (2)

## **AS A REMINDER:**

### **IMPORTANT SAFETY INSTRUCTIONS**

**WARNING:** When using electric tools, basic precautions should be followed to reduce the risk of fire, electric shock and personal injury.

**READ & FOLLOW ALL INSTRUCTIONS:** This tool was designed for specific applications. Norfield Industries strongly recommends that this tool NOT be modified and/or used for applications other than those for which it was designed.

If you have any questions about additional applications or uses, DO NOT attempt those uses or modifications until you have been advised by a qualified Norfield Representative. Any and all modifications to or misuses of the tool will void all warranties.

#### **A. Avoid dangerous environments**

Do not expose equipment to rain or use in damp conditions.  
Do not use tool in presence of flammable liquids or gases.

#### **B. Dress properly**

Do not wear loose clothing or jewelry. Loose clothing, drawstrings and jewelry can be caught in moving parts. Wear protective hair covering to contain long hair.

#### **C. ALWAYS use safety glasses**

#### **D. Maintain machine tools properly**

Keep cutters sharp and clean for better and safer performance.  
Always use correct-size cutters.  
Inspect all electrical cords periodically and replace if damaged.

#### **E. Disconnect electrical supply cord**

Always disconnect cord before servicing, cleaning, changing cutters or adding accessories.

#### **F. Stay alert**

Watch what you are doing. Use common sense. Do not operate equipment when you are tired or under the influence of medication, alcohol or drugs.

## **SAVE THESE INSTRUCTIONS**